



**Fabricast Valve Company**  
1061 Industrial Way, Longview, WA 98632  
**Toll-Free** 1-877-264-2503  
**Local** (360) 425-0306 **Fax** (360) 425-0353  
www.knifegates.com  
sales@fabricastvalve.com

# FIG 7 / 27

FIG 7 / 27

The Fabricast FIG 7/27 is a fabricated and welded Swing Check Valve. Designed and tested to MSS SP61 and ASME B16.5 specifications.

#### Features

- Heavy duty fabricated 304 or 316 stainless steel body and gate disc. Standard range is 2" - 48"
- 150 PSI CWP rated up to 24".

Drip tight reverse flow seating to MSS SP61

- Precision CNC machined valve body and gate disc.
- Economy design is fully enclosed.

Note - For horizontal mounting orientations

#### Options

- Other Alloys - 317L, Duplex 2205, 904L
- Removable inspection cover and outside shaft with or without counterweight.



**FIG 7**

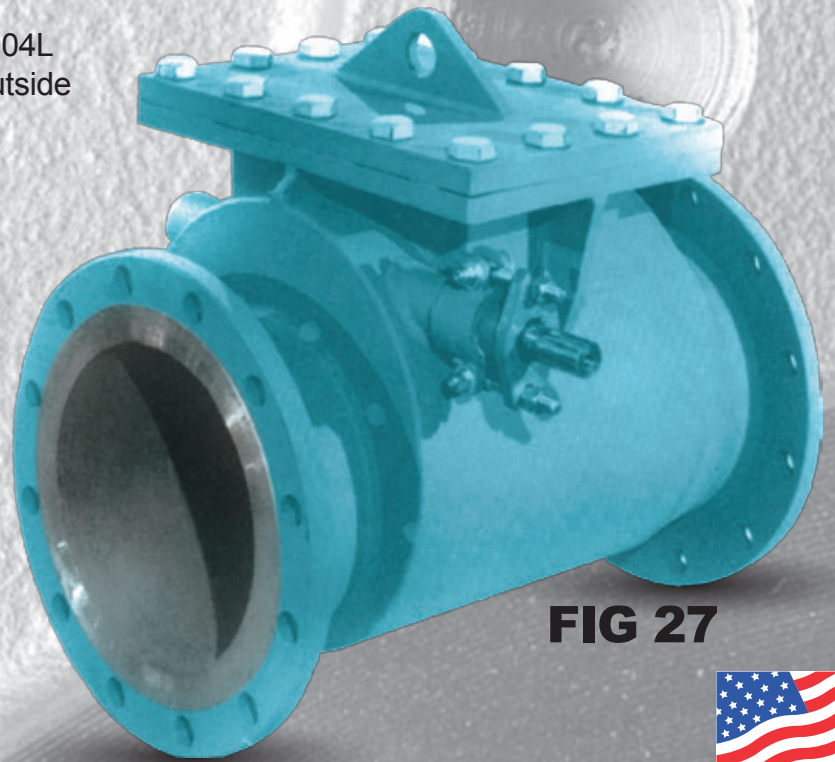

**FIG 27**

Fabricast Valve

**Previous Model**  
**FV-150-SCV**





**Fabricast Valve Company**  
 1061 Industrial Way, Longview, WA 98632  
**Toll-Free 1-877-264-2503**  
**Local (360) 425-0306 Fax (360) 425-0353**  
 www.knifegates.com  
 sales@fabricastvalve.com

# FIG 7 / 27

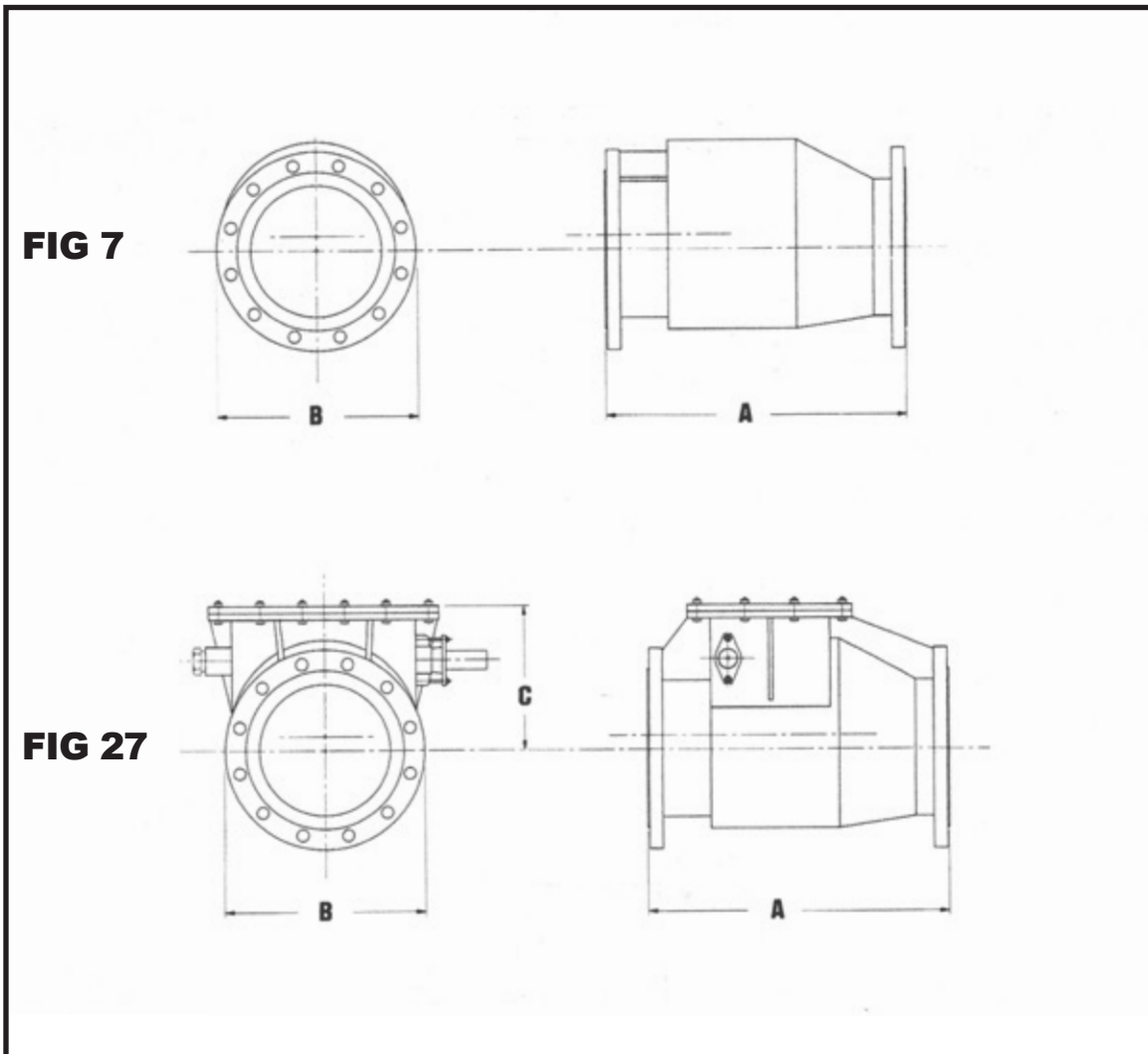

SIZE	3	4	6	8	10	12	14	16	18	20	24
F-F	9.5	11.5	16	19.5	24.5	27.5	31	36	38.5	38.5	51
MIN	7	9	10.75	14.63	16.38	18.63	21.38	23.38	24.25	26	33
FLG	7.5	9	11	13.5	16	19	21	23.5	25	27.5	32
7 WT	22	35	50	99	135	200	245	290	350	425	635
27 WT	49	55	83	159	231	387	419	512	670	710	819